

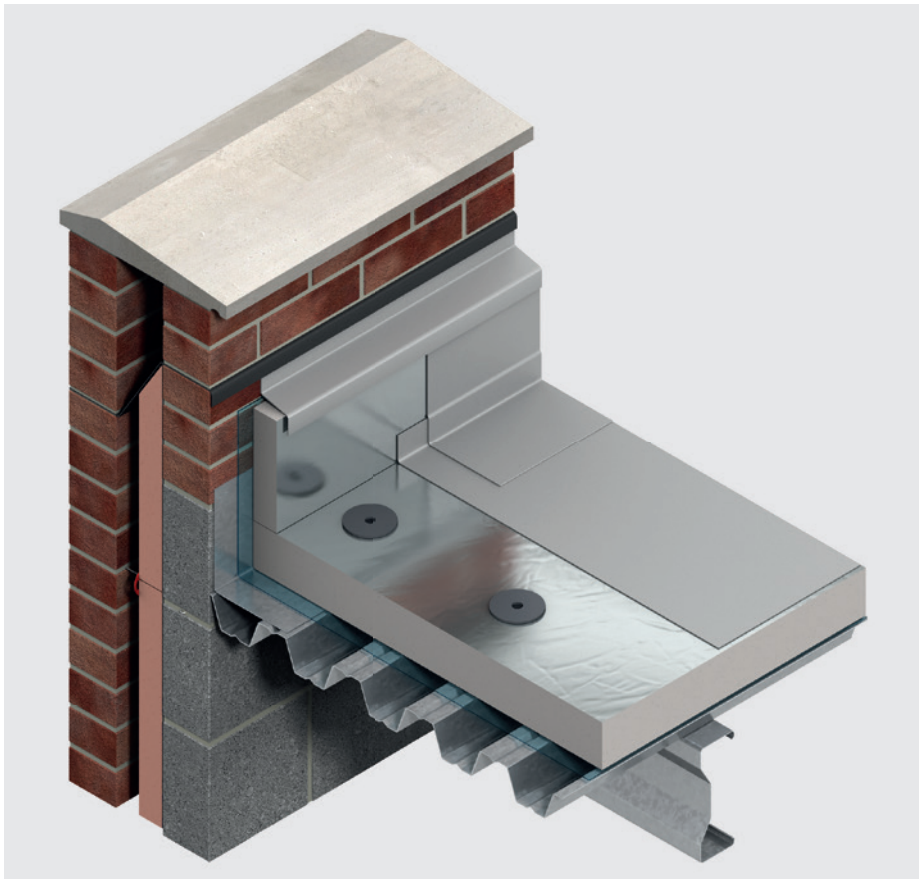

# QuadCore® 426 Roofboard

Insulation for Flat Roofs Waterproofed with Mechanically Fixed Single-Ply Waterproofing



- High performance rigid thermoset insulation - thermal conductivity 0.021 W/mK
- For FM approval see page 14
- Fully compatible with most mechanically fixed single-ply waterproofing systems
- Compatible with most green roof systems
- Installation technique is ideal for fast track building programmes
- Resistant to the passage of water vapour
- Easy to handle and install
- Ideal for new build and refurbishment
- Non-deleterious material
- Manufactured with a blowing agent that has zero ODP and low GWP

# Typical Constructions and U-values

## Assumptions

The U-values in the tables that follow have been calculated, under a management system certified to the BBA Scheme for Assessing the Competency of Persons to Undertake U-value and Condensation Risk Calculations, using the method detailed in BS EN ISO 6946: 2017 / I.S. EN ISO 6946: 2007 (Building components and building elements. Thermal resistance and thermal transmittance. Calculation methods), and using the conventions set out in BR 443 (Conventions for U-value calculations). They are valid for the constructions shown in the details immediately above each table.



These examples are based on Kingspan QuadCore® 426, waterproofed using a mechanically fixed single-ply membrane. The insulation board is mechanically fixed through a sealed metal deck, or over a vapour control layer, which has itself been loose-laid directly over the type of deck stated for each application. The ceiling, where applicable, is taken to be a 3 mm skim coated 12.5 mm plasterboard with a cavity between it and the underside of the deck.

NB When calculating U-values to BS EN ISO 6946: 2017 / I.S. EN ISO 6946: 2007, the type of mechanical fixing used may change the thickness of insulation required. These calculations assume telescopic tube fasteners with a thermal conductivity of 1.00 W/mK or less, the effect of which is insignificant.

NB For the purposes of these calculations the standard of workmanship has been assumed good, and therefore the correction factor for air gaps has been ignored.

NB The figures quoted are for guidance only. A detailed U-value calculation and a condensation risk analysis should be completed for each project.

NB If your construction is different for those specified, and / or to gain a comprehensive U-value calculation along with a condensation risk analysis for your project, please consult Kingspan Insulation's Technical Service Department (see rear cover for details).

## Concrete Deck

### Dense Concrete Deck with Suspended Ceiling

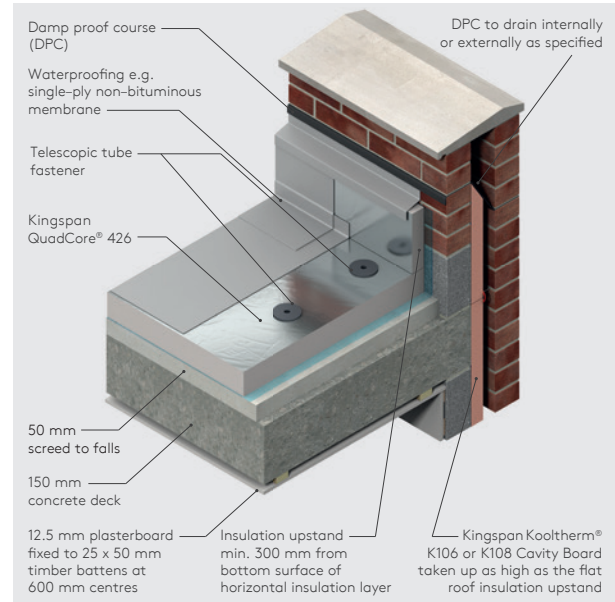

Figure 1

Insulant Thickness (mm)	U-values (W/m <sup>2</sup> K)
100	0.19
105	0.18
110	0.17
115	0.17
120	0.16
125	0.15
130	0.15
135	0.14
140	0.14
145	0.14
150	0.13

NB Refer to local distributor or Kingspan Insulation price list for current stock and non-stock sizes.

# Typical Constructions and U-values

## Timber Deck

### Timber Deck with Plasterboard Ceiling

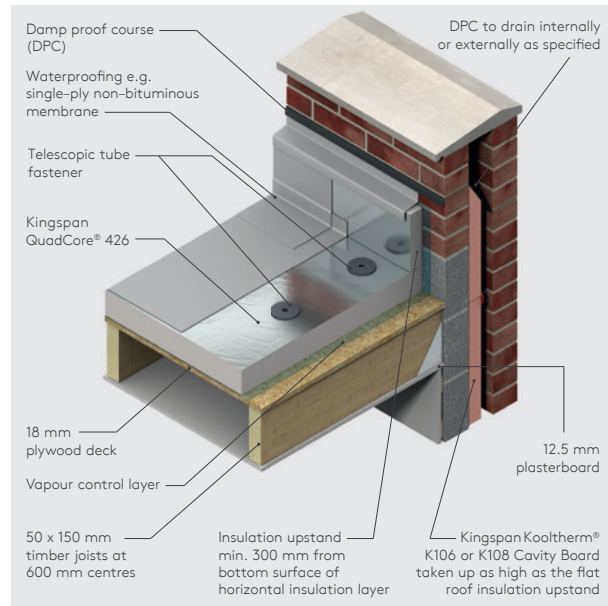

Figure 2

Insulant Thickness (mm)	U-values (W/m <sup>2</sup> K)
100	0.19
105	0.18
110	0.17
115	0.17
120	0.16
125	0.15
130	0.15
135	0.14
140	0.14
145	0.13
150	0.13

NB Refer to local distributor or Kingspan Insulation price list for current stock and non-stock sizes.

## Metal Deck

### Metal Deck with No Ceiling

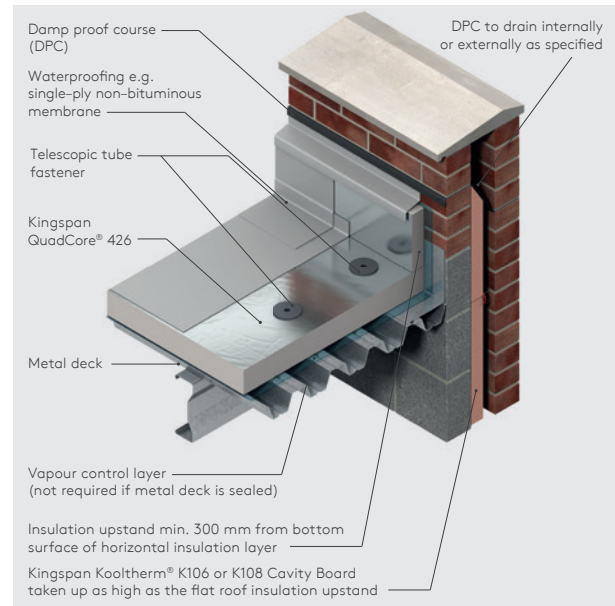

Figure 3

Insulant Thickness (mm)	U-values (W/m <sup>2</sup> K)
100	0.22
105	0.19
110	0.19
115	0.18
120	0.17
125	0.16
130	0.16
135	0.15
140	0.15
145	0.14
150	0.14

NB Refer to local distributor or Kingspan Insulation price list for current stock and non-stock sizes.

# Typical Constructions and U-values

## Green Roof Systems

### Extensive Green Roof Covering - Metal Deck with No Ceiling

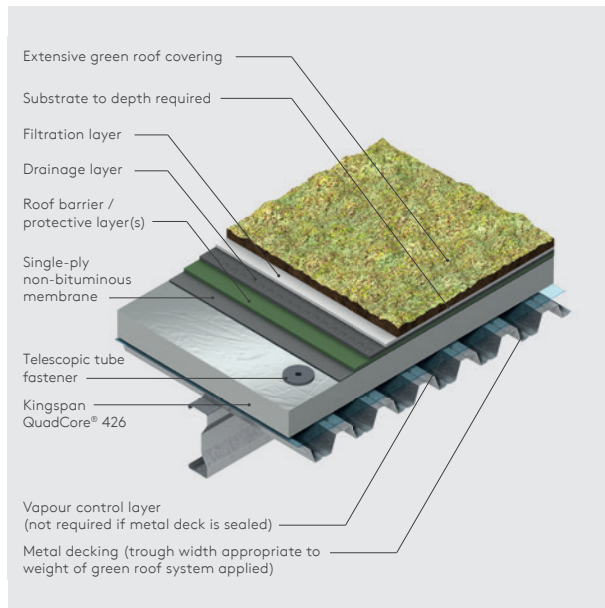

Figure 4

Insulant Thickness (mm)	U-values (W/m <sup>2</sup> K)
100	0.22
105	0.19
110	0.19
115	0.18
120	0.17
125	0.16
130	0.16
135	0.15
140	0.15
145	0.14
150	0.14

NB Refer to local distributor or Kingspan Insulation price list for current stock and non-stock sizes.

### Semi-Intensive Green Roof Covering - Dense Concrete Deck with Suspended Ceiling

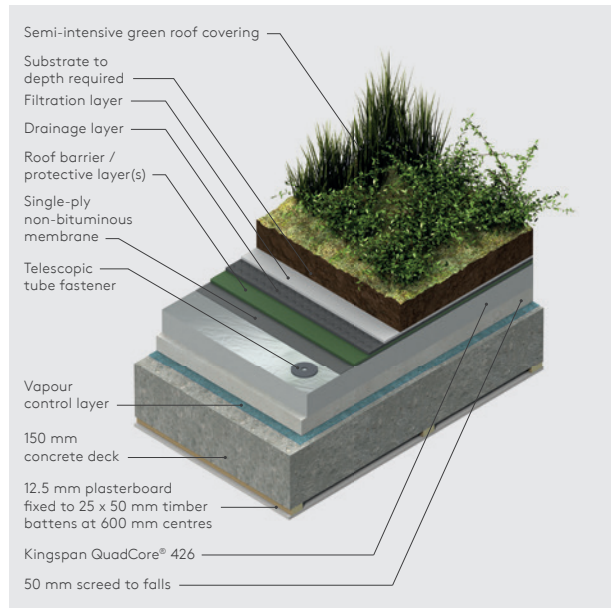

Figure 5

Insulant Thickness (mm)	U-values (W/m <sup>2</sup> K)
100	0.19
105	0.18
110	0.17
115	0.17
120	0.16
125	0.15
130	0.15
135	0.14
140	0.14
145	0.14
150	0.13

NB Refer to local distributor or Kingspan Insulation price list for current stock and non-stock sizes.

---

# Design Considerations

---

## Linear Thermal Bridging

### Basic Principles

Linear thermal bridging describes the heat loss / gain that occurs at junctions between elements e.g. where an external wall meets the roof, or at junctions around openings in the building fabric where the thermal insulation layer is discontinuous e.g. sills, jambs and lintels.

Interruptions within the insulation layer by materials with poorer insulating properties can result in a thermal bridge, which in turn can lead to problems of condensation and mould growth, especially if there is a drop in surface temperature.

The heat flow at these junctions and opening locations, over and above that through the adjoining plane elements, is the linear thermal transmittance of the thermal bridge: measured in W/mK; referred to as a 'psi-value'; and expressed as a ' $\psi$ -value'.

The lower the  $\psi$ -value, the better the performance.  $\psi$ -values are taken into account in the calculation methodologies e.g. the Standard Assessment Procedure (SAP), that are used to assess the operational CO<sub>2</sub> emissions and, where applicable, the fabric energy efficiency of buildings.

$\psi$ -values can comprise either, or a combination of, approved, calculated or assumed values.

### Reducing Linear Thermal Bridging

Detailing at junctions to minimise the effects of thermal bridging and the associated risk of condensation or mould growth is important and there are some simple design considerations that can be adopted to help mitigate the risks and to reduce heat losses.

- Care is required to ensure continuation of insulation wherever possible between the wall and roof for best thermal performance. Where this is not possible, the roof and wall insulation should be overlapped and ideally, insulation material introduced between.
- Parapet detailing can represent a good, low heat loss approach, with insulation continuity maintained using an insulated upstand to reduce cold bridging. A minimum 50 mm thick Kingspan QuadCore® 426 upstand should be used around the perimeter of the roof on the internal façade of parapets. The upstand should extend a minimum of 150 mm above the roof insulation and achieve a minimum distance of 300 mm between the top of the insulation upstand and the bottom of the horizontal roof insulation. Wall insulation should be carried up into parapets at least as high as the flat roof insulation upstand.

- Lightweight aggregate blockwork to the inner leaf of wall constructions can help to improve thermal performance at junctions generally and where used for the inner leaf of parapet walls it can help to reduce losses.
- Where a parapet construction is not used, to achieve best performance, the roof insulation should be carried over the wall plate to meet and extend past the wall insulation layer. For a timber warm roof construction, the first joist zone above the wall plate can be filled with insulation for best performance and to maintain thermal continuity.
- For best thermal performance, roof-lights and ventilator kerbs should be insulated with the same thickness of Kingspan QuadCore® 426 as the general roof area.
- Where guttering is incorporated within a flat roof construction, this should be accounted for within the overall thermal design of the roof via an area-weighted calculation for the whole roof; the risk of localised interstitial condensation from reduced insulation provision at the gutter should be considered.

---

## Responsible Sourcing

Kingspan QuadCore 426® is manufactured under a management system certified to ISO 14001: 2015 (Environmental Management Systems. Requirements).

NB The above information is correct at the time of writing. Please confirm at the point of need by contacting Kingspan Insulation's Technical Service Department (see rear cover for details), from which copies of Kingspan Insulation's certificates can be obtained.

---

# Design Considerations

---

## Sustainability & Responsibility

Kingspan Insulation has a long-term commitment to sustainability and responsibility: as a manufacturer and supplier of insulation products; as an employer; as a substantial landholder; and as a key member of its neighbouring communities.

A report covering the sustainability and responsibility of Kingspan Insulation Ltd's operations at its Pembridge, Herefordshire and Selby, North Yorkshire manufacturing facilities is available at [www.kingspaninsulation.co.uk/sustainabilityandresponsibility](http://www.kingspaninsulation.co.uk/sustainabilityandresponsibility).

---

## Specification Clause

Kingspan QuadCore® 426 should be described in specifications as:

The roof insulation shall be Kingspan QuadCore® 426 \_\_\_\_\_mm thick: comprising a high performance fibre-free rigid neo-thermoset insulation core faced on both sides with a low emissivity composite foil facing. The product shall be manufactured: with a blowing agent that has zero Ozone Depletion Potential (ODP) and low Global Warming Potential (GWP); in accordance with the requirements of BS 4841-4; under a management system certified to ISO 9001: 2015, ISO 14001: 2015, BS OHSAS 18001: 2007 and ISO 50001: 2011; by Kingspan Insulation Limited; and installed in accordance with the instructions issued by them.

---

## NBS Specifications

Details also available in NBS Plus.  
NBS users should refer to clause(s):  
J42 420, J42 430 (Standard and Intermediate)  
J42 10 (Minor Works).



## Building Information Modelling (BIM)

Kingspan Insulation's BIM objects can be downloaded in Revit and in IFC formats. For more information please visit [www.kingspaninsulation.co.uk/bim](http://www.kingspaninsulation.co.uk/bim).

Kingspan QuadCore® 426 is also available as part of various layer sets for typical construction build-ups.

To obtain these objects or layer sets please contact Kingspan Insulation's Technical Service Department (see rear cover for details).

## Wind Loading

Wind loadings should be assessed in accordance with BS / I.S. EN 1991-1-4: 2005 + A1: 2010 (National Annex to Eurocode 1 Actions on Structures. General Actions. Wind Actions) taking into account:

- length / width / height of the building;
  - orientation of the building;
  - wind speed;
  - aspect (e.g. on a hill side); and
  - topographical value of the surrounding area.
- 

## Falls

The fall on a flat roof, constructed using Kingspan QuadCore® 426, is normally provided by the supporting structure being directed towards the rainwater outlets. The fall should be smooth and steep enough to prevent the formation of rainwater ponds. In order to ensure adequate drainage, BS 6229: 2018 (Flat roofs with continuously supported coverings - code of practice) recommends a designed fall of 1:40 to ensure a minimum finished fall of 1:80 is achieved.

---

## Roof Waterproofing

Kingspan QuadCore® 426 is suitable for use with most mechanically fixed single-ply waterproofing membranes.

NB Kingspan QuadCore® 426 is not suitable for use with bitumen based built-up waterproofing systems or mastic asphalt. Kingspan Therमारoof® TR27 LPC/FM can be used instead in these applications.

---

# Design Considerations

---

## Water Vapour Control

Kingspan QuadCore® 426 should be installed over a vapour control layer, in new build roofs, unless it is being used in conjunction with a sealed metal deck. Regardless of the deck type it is recommended that a condensation risk analysis is carried out for every project.

For refurbishment projects, involving the addition of insulation to existing insulated flat roofs, or roofs constructed of insulated steel faced composite panels, it is imperative that a U-value calculation and condensation risk analysis is carried out for every project, in order to ensure that the correct thickness of insulation is installed to achieve the required thermal performance, whilst avoiding interstitial condensation.

In refurbishment projects, where Kingspan QuadCore® 426 is to be installed over an existing bituminous waterproofing membrane, the membrane can be used as a vapour control layer, as long as it is in a good water tight condition. Where this is not the case, a separate vapour control layer should be installed.

As a minimum the vapour control layer should consist of a 1000 gauge (250 micron) polythene sheet, with all joints lapped and then sealed with double sided self adhesive tape.

---

## Roof Loading / Traffic

Kingspan QuadCore® 426 is suitable for use on access roof decks subject to limited foot traffic.

Where inappropriate foot traffic is liable to occur it is recommended that the roof surface is protected by specially constructed walk-ways.

For further advice on the acceptability of specific foot traffic regimes, please contact Kingspan Insulation's Technical Service Department (see rear cover for details).

## Spanning on Metal Decks

Insulation boards should comply with the minimum thicknesses detailed within BS 4841-3: 2006 shown in the table below, when used over metal decks with trough openings.

Trough Opening (mm)	Minimum Insulant Thickness (mm)
≤ 75	25
76-100	30
101-125	35
126-150	40
151-175	45
176-200	50
201-225	55
226-250	60

---

## Green Roofs

Kingspan QuadCore® 426 is suitable for use under most green roof systems.

Green roof systems are a specialist design area. When designing a loose-laid insulated green roof assembly consideration needs to be given to the following.

Green roof systems are required to have a minimum dry weight of 80 kg/m<sup>2</sup> to ballast the insulation boards beneath them. However, the total required dry weight will depend upon wind uplift, which in turn will vary with the geographical location of the building, local topography, and the height and width of the roof concerned. The necessity for any additional dry weight should be assessed in accordance with BS / I.S. EN 1991-1-4: 2005 + A1: 2010 (National Annex to Eurocode 1 Actions on structures. General Actions. Wind Actions).

When installing a loose-laid insulated green roof assembly, any insulation must be immediately over-laid with the green roof system, which must meet all of the requirements outlined above.

Where these requirements cannot be ensured, the insulation must be mechanically fixed (see Sitework). For further information please contact Kingspan Insulation's Technical Service Department (see rear cover for details).

---

## Lightning Protection

Building designers should give consideration to the requirements of BS / I.S. EN 62305: 2011 (Protection against lightning).



---

# Sitework

---

## Installing over Metal Decks

- Where an FM approved construction is required, please refer to 'FM Approval' on page 14.
- Metal decks should be clean, dry, without large projections, steps or gaps, and should be graded to allow correct falls to all rainwater outlets.
- If using a sealed metal deck there is no requirement for a separate vapour control layer.
- If the metal deck is not sealed the vapour control layer should be loose-laid.
- Where one run of the specified vapour control layer laps another, there should be minimum 150 mm side and end overlaps, which should be adequately sealed.
- Turn up the vapour control layer at the edge of the roof to a height appropriate to the specified waterproofing membrane.
- Boards of Kingspan QuadCore® 426 should be secured to the deck using mechanical fixings e.g. telescopic tube fasteners (see 'Mechanical Fixings').
- Insulation boards should always be laid break-bonded, either with their long edges at right angles to the trough openings, or diagonally across the corrugation line, and with joints lightly butted. There should be no gaps at abutments.
- Roof-light or ventilator kerbs etc. should always be insulated with the same thickness of Kingspan QuadCore® 426 as the general roof area.
- A 50 mm thick Kingspan QuadCore® 426 upstand should be used around the perimeter of the roof on the internal façade of parapets.
- A minimum distance of 300 mm should be maintained between the top of the insulation upstand and the bottom of the horizontal roof insulation.
- For roofs without parapets, a timber edging batten of the same height of the insulation is to be used to fix the fascia board to the gutter system. Please contact the membrane manufacturer for more details.
- The waterproofing membrane is mechanically fixed in accordance with the membrane manufacturer's instructions, over the whole insulated area including any insulation upstands, as soon as possible after laying the insulation boards.

## Installing over Concrete Decks

- Concrete decks should be clean, dry, without large projections, steps or gaps, and should be graded to allow correct falls to all rainwater outlets.
- The vapour control layer should be loose-laid over the deck.
- Where one run of the specified vapour control layer laps another, there should be minimum 150 mm side and end overlaps, which should be adequately sealed.
- Turn up the vapour control layer at the edge of the roof to a height appropriate to the specified waterproofing membrane.
- Boards of Kingspan QuadCore® 426 should be secured to the deck using mechanical fixings e.g. telescopic tube fasteners (see 'Mechanical Fixings').
- Insulation boards should always be laid break-bonded, either with their long edges at right angles to the edge of, or diagonally across the roof, and with joints lightly butted. There should be no gaps at abutments.
- Roof-light or ventilator kerbs etc. should always be insulated with the same thickness of Kingspan QuadCore® 426 as the general roof area.
- A 50 mm thick Kingspan QuadCore® 426 upstand should be used around the perimeter of the roof on the internal façade of parapets.
- A minimum distance of 300 mm should be maintained between the top of the insulation upstand and the bottom of the horizontal roof insulation.
- For roofs without parapets, a timber edging batten of the same height of the insulation is to be used to fix the fascia board to the gutter system. Please contact the membrane manufacturer for more details.
- The waterproofing membrane is mechanically fixed in accordance with the membrane manufacturer's instructions, over the whole insulated area including any insulation upstands, as soon as possible after laying the insulation boards.



## Installing over Plywood Decks

- Timber decks should be clean, dry, without large projections, steps or gaps, and should be graded to allow correct falls to all rainwater outlets.
- The vapour control layer should be temporarily stapled or nailed to the deck.
- Where one run of the specified vapour control layer laps another, there should be minimum 150 mm side and end overlaps, which should be adequately sealed.
- Turn up the vapour control layer at the edge of the roof to a height appropriate to the specified waterproofing membrane.
- Boards of Kingspan QuadCore® 426 should be secured to the deck using mechanical fixings e.g. telescopic tube fasteners (see 'Mechanical Fixings').
- Insulation boards should always be laid break-bonded, either with their long edges at right angles to the edge of, or diagonally across the roof, and with joints lightly butted. There should be no gaps at abutments.
- Joints between insulation boards should not coincide with those between the plywood sheets.
- Roof-light or ventilator kerbs etc. should always be insulated with the same thickness of Kingspan QuadCore® 426 as the general roof area.
- A 50 mm thick Kingspan QuadCore® 426 upstand should be used around the perimeter of the roof on the internal façade of parapets.
- A minimum distance of 300 mm should be maintained between the top of the insulation upstand and the bottom of the horizontal roof insulation.
- For roofs without parapets, a timber edging batten of the same height of the insulation is to be used to fix the fascia board to the gutter system. Please contact the membrane manufacturer for more details.
- The waterproofing membrane is mechanically fixed in accordance with the membrane manufacturer's instructions, over the whole insulated area including any insulation upstands, as soon as possible after laying the insulation boards.

## Installing over Existing Flat Roofs

- The existing waterproofing membrane surface should be clean, dry, without large projections, steps or gaps, and should be graded to allow correct falls to all rainwater outlets.
- Where the existing waterproofing membrane is not fit for purpose as a vapour control layer, a separate vapour control layer should be loose-laid over it.
- Where one run of the specified vapour control layer laps another, there should be minimum 150 mm side and end overlaps, which should be adequately sealed.
- Turn up the vapour control layer at the edge of the roof to a height appropriate to the specified new waterproofing membrane.
- Boards of Kingspan QuadCore® 426 should be secured to the deck using mechanical fixings e.g. telescopic tube fasteners (see 'Mechanical Fixings').
- Insulation boards should always be laid break-bonded, either with their long edges at right angles to the edge of, or diagonally across the roof, and with joints lightly butted. There should be no gaps at abutments.
- Roof-light or ventilator kerbs etc. should always be insulated with the same thickness of Kingspan QuadCore® 426 as the general roof area.
- A 50 mm thick Kingspan QuadCore® 426 upstand should be used around the perimeter of the roof on the internal façade of parapets.
- A minimum distance of 300 mm should be maintained between the top of the insulation upstand and the bottom of the horizontal roof insulation.
- For roofs without parapets, a timber edging batten of the same height of the insulation is to be used to fix the fascia board to the gutter system. Please contact the membrane manufacturer for more details.
- The waterproofing membrane is installed in accordance with the membrane manufacturer's instructions, over the whole insulated area including any insulation upstands, as soon as possible after laying the insulation boards.

## Installing over Existing Composite Panel Roofs

- If the existing profile provides inadequate support for the insulation boards, the existing roof should be over-boarded, e.g. with plywood, prior to their installation.
- Boards of Kingspan QuadCore® 426 should be secured to the deck using mechanical fixings. Please refer to Kingspan Insulation's Technical Service Department (see rear cover for details) for advice on fixing specification.
- Insulation boards should always be laid break-bonded and with joints lightly butted. There should be no gaps at abutments. If the existing roof has been over-boarded, then insulation boards should be laid with their long edges at right angles to the edge of, or diagonally across the roof. If not, they should be laid either with their long edges at right angles to the trough openings, or diagonally across the corrugation line.
- Roof-light or ventilator kerbs etc. should always insulated with the same thickness of Kingspan QuadCore® 426 as the general roof area.
- The waterproofing membrane is installed in accordance with the membrane manufacturer's instructions, over the whole insulated area including any insulation upstands, as soon as possible after laying the insulation boards.

## Mechanical Fixings

- The number of mechanical fixings required to fix Kingspan QuadCore® 426 will vary with the geographical location of the building, the local topography, and the height and width of the roof concerned along with the deck type.
- A minimum of 6 fixings are required to secure boards of Kingspan QuadCore® 426 to the deck.
- The requirement for additional fixings should be assessed in accordance with BS / I.S. EN 1991-1-4: 2005 + A1: 2010 (National Annex to Eurocode 1. Actions on structures. General Actions. Wind Actions).
- Mechanical fixings must be arranged in an even pattern.
- Fasteners at insulation board edges must be located > 50 mm and < 150 mm from edges and corners of the board and not overlap board joints.
- Please refer to page 12 for recommended fixing patterns.
- Each fixing should incorporate a square or circular plate washer (50 x 50 mm or 50 mm diameter).
- If two layers of insulation are to be installed, the base layer should be mechanically fixed with minimum 1 No. fixing in the centre of the board before fixing the top layer as described above.

- Where alternative mechanical fixing systems are specified, such as bar fixing systems, the specified system must give similar restraint to the insulation board as would be attained by the use of conventional telescopic tube fasteners.

- For details on fixings refer to:

**Ejot UK Limited** +44 (0) 1977 687 040  
[www.ejot.co.uk](http://www.ejot.co.uk)

**Fixfast** +44 (0) 1732 882 387  
[www.fixfast.com](http://www.fixfast.com)

**MAK Fasteners** +353 (0) 1 451 9004  
[www.makfasteners.com](http://www.makfasteners.com)

**SFS Intec** +44 (0) 1132 085 500  
[www.sfsintec.biz/uk](http://www.sfsintec.biz/uk)

## Installing in Two Layers

- In situations where two layers of insulation are required, both layers should be installed in the same manner, as detailed in the preceding sections. However, refer to 'Mechanical Fixings' for guidance on the number of fixings to be used in each layer.
- In all cases, the layers should be horizontally offset relative to each other so that, as far as possible, the board joints in the two adjacent layers do not coincide with each other (see Figure 6).

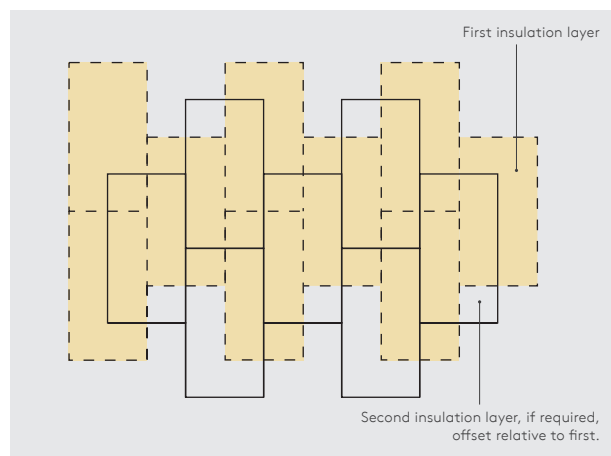

Figure 6 Offsetting of Multiple Insulation Layers

---

# Sitework

---

## General

### Following Trades

- The roof must be adequately protected when building works are being carried out on or over the roof surface. This is best achieved by close boarding. The completed roof must not be used for storage of heavy building components such as bricks or air conditioning equipment.

### Daily Working Practice

- At the completion of each day's work, or whenever work is interrupted for extended periods of time, a night joint must be made in order to prevent water penetration into the roof construction.

### Cutting

- Cutting should be carried out either by using a fine toothed saw, or by scoring with a sharp knife, snapping the board over a straight edge and then cutting the facing on the other side.
- Ensure accurate trimming to achieve close-butting joints and continuity of insulation.

### Availability

- Kingspan QuadCore® 426 is available through specialist insulation distributors and selected roofing merchants throughout the UK and Ireland.

### Packaging and Storage

- The polyethylene packaging of Kingspan Insulation products, which is recyclable, should not be considered adequate for outdoor protection.
- Ideally, boards should be stored inside a building. If, however, outside storage cannot be avoided, then the boards should be stacked clear of the ground and covered with an opaque polythene sheet or weatherproof tarpaulin. Boards that have been allowed to get wet should not be used.

## Health and Safety

- Kingspan Insulation products are chemically inert and safe to use.
- A Safety Information Data Sheet for this product is available from the Kingspan Insulation website [www.kingspaninsulation.co.uk/safety](http://www.kingspaninsulation.co.uk/safety) or [www.kingspaninsulation.ie/safety](http://www.kingspaninsulation.ie/safety).

Please note that the reflective surface on this product is designed to enhance its thermal performance. As such, it will reflect light as well as heat, including ultraviolet light. Therefore, if this board is being installed during very bright or sunny weather, it is advisable to wear UV protective sunglasses or goggles, and if the skin is exposed for a significant period of time, to protect the bare skin with a UV block sun cream.

The reflective facing used on this product can be slippery underfoot when wet. Therefore, it is recommended that any excess material should be contained to avoid a slip hazard.

Warning - do not stand on or otherwise support your weight on this board unless it is fully supported by a load bearing surface.

# Mechanical Fixing Patterns

## Recommended Fixing Patterns

The recommended fixing patterns for Kingspan QuadCore® 426 are shown below. The number of fixings necessary should be assessed in accordance with BS / I.S. EN 1991-1-4: 2005 + A1: 2010 (National Annex to Eurocode 1. Actions on structures. General Actions. Wind Actions).

The images below show the recommended fixing pattern, the number of fixings used and the resulting fixing rate shown as the number of fixings per m<sup>2</sup>.

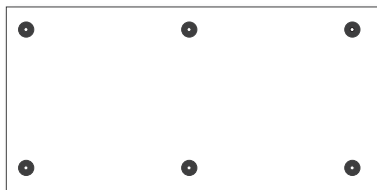

6 No. per board  
(2.4 x 1.2 m board - 2.08 fixings / m<sup>2</sup>)

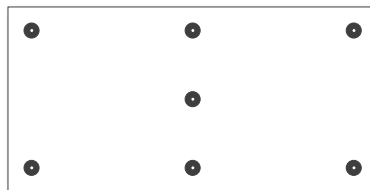

7 No. per board  
(2.4 x 1.2 m board - 2.43 fixings / m<sup>2</sup>)

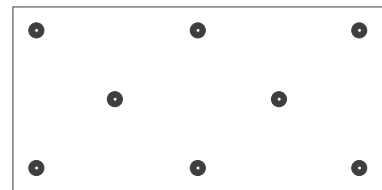

8 No. per board  
(2.4 x 1.2 m board - 2.77 fixings / m<sup>2</sup>)

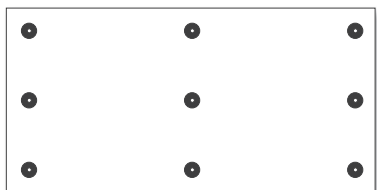

9 No. per board  
(2.4 x 1.2 m board - 3.12 fixings / m<sup>2</sup>)

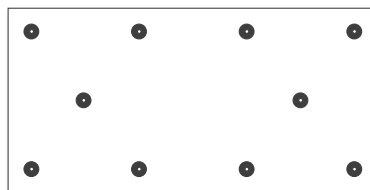

10 No. per board  
(2.4 x 1.2 m board - 3.47 fixings / m<sup>2</sup>)

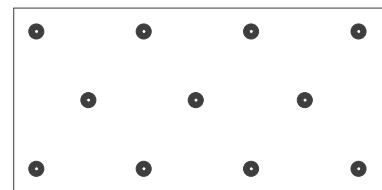

11 No. per board  
(2.4 x 1.2 m board - 3.81 fixings / m<sup>2</sup>)

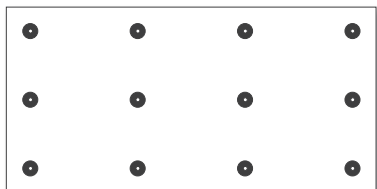

12 No. per board  
(2.4 x 1.2 m board - 4.16 fixings / m<sup>2</sup>)

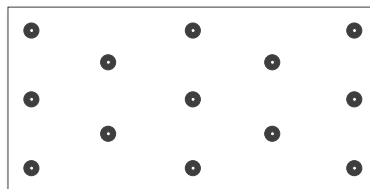

13 No. per board  
(2.4 x 1.2 m board - 4.51 fixings / m<sup>2</sup>)

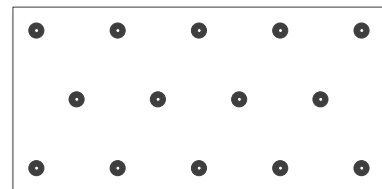

14 No. per board  
(2.4 x 1.2 m board - 4.86 fixings / m<sup>2</sup>)

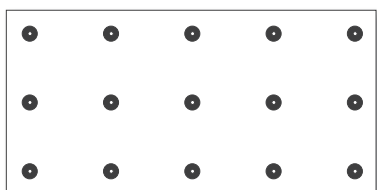

15 No. per board  
(2.4 x 1.2 m board - 5.20 fixings / m<sup>2</sup>)

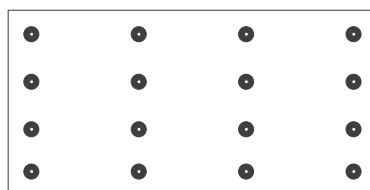

16 No. per board  
(2.4 x 1.2 m board - 5.55 fixings / m<sup>2</sup>)

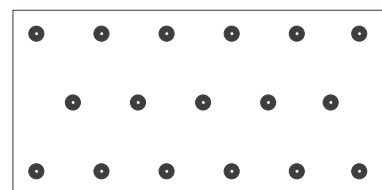

17 No. per board  
(2.4 x 1.2 m board - 5.90 fixings / m<sup>2</sup>)

NB Mechanical fixings e.g. telescopic tube fasteners, must be arranged in an even pattern. Fasteners at board edges must be located > 50 mm and < 150 mm from edges and corners of the board and not overlap board joints.

---

# Product Details

---

## The Facings

Kingspan QuadCore® 426 is faced on both sides with a low emissivity composite foil, autohesively bonded to the insulation core during manufacture.

## The Core

The core of Kingspan QuadCore® 426 is a high performance fibre-free rigid neo-thermoset insulant manufactured with a blowing agent that has zero Ozone Depletion Potential (ODP) and low Global Warming Potential (GWP).



## Standards and Approvals

Kingspan QuadCore® 426 is manufactured to the highest standards in accordance with requirements BS 4841-4 (Rigid polyisocyanurate (PIR) and polyurethane (PUR) products for building end-use applications. Specification for laminated boards (roofboards) with auto-adhesively or separately bonded facings for use as roofboard thermal insulation under single-ply roofing membranes).

Kingspan QuadCore® 426 is also manufactured to the highest standards under a management system certified to ISO 9001: 2015 (Quality management systems. Requirements), ISO 14001: 2015 (Environmental Management Systems. Requirements), BS OHSAS 18001: 2007 (Occupational Health and Safety Management Systems. Requirements) and ISO 50001: 2011 (Energy Management Systems. Requirements with Guidance for Use).

## Standard Dimensions

Kingspan QuadCore® 426 is available in the following standard size:

Nominal Dimension		Availability
Length	(m)	2.4
Width	(m)	1.2
Insulant Thickness	(mm)	Refer to local distributor or Kingspan Insulation price list for current stock and non-stock sizes.

## Compressive Strength

The compressive strength of Kingspan QuadCore® 426 typically exceeds 150 kPa at 10% compression, when tested to BS / I.S. EN 826: 2013 (Thermal insulating products for building applications. Determination of compression behaviour).

The compressive creep of Kingspan QuadCore® 426 achieved 22.5 kPa at 3% creep and total thickness reduction over 10 years, when tested to BS / I.S. EN 1606: 2013 (Thermal insulating products for building applications. Determination of compressive creep).

## Water Vapour Resistance

Kingspan QuadCore® 426 achieves a resistance far greater than 100 MNs/g, when tested in accordance with BS / I.S. EN 12086: 2013 (Thermal insulating products for building applications. Determination of water vapour transmission properties). QuadCore® 426 should always be installed over a vapour control layer or sealed metal deck (see 'Water Vapour Control' on page 7).

## Durability

If correctly installed, Kingspan QuadCore® 426 can have indefinite life. Its durability depends on the supporting structure and the conditions of its use.

## Resistance to Solvents, Fungi & Rodents

The insulation core is resistant to short-term contact with petrol and with most dilute acids, alkalis and mineral oils. However, it is recommended that any spills be cleaned off fully before the boards are installed. Ensure that safe methods of cleaning are used, as recommended by the suppliers of the spilt liquid. The insulation core is not resistant to some solvent-based adhesive systems, particularly those containing methyl ethyl ketone. Adhesives containing such solvents should not be used in association with this product. Damaged boards or boards that have been in contact with harsh solvents or acids should not be used.

The insulation core and facings used in the manufacture of Kingspan QuadCore® 426 resist attack by mould and microbial growth, and do not provide any food value to vermin.

# Product Details

## Fire Performance

Roofing systems incorporating Kingspan QuadCore® 426, when subjected to the external roof exposure test specified in the table below, can achieve the results shown. However performance is reliant on the roof covering, therefore for further details please contact your roofing system supplier or waterproof membrane manufacturer.

Test	Classification
BS 476-3: 2004	EXT.F.AA
DD CEN/TS 1187: 2012	B <sub>ROOF</sub> (t4)

## FM Approval

Upon request, Kingspan QuadCore® 426 is available with FM Approval to FM 4470 (Approval Standard for Single-Ply, Polymer-Modified Bitumen Sheet, Built-Up Roof (BUR) and Liquid Applied Roof Assemblies for use in Class 1 and Non-combustible Roof Deck Construction) December 2016, subject to conditions of approval. Please contact Kingspan Insulation's Sales Department (see rear cover for details).



Not all thicknesses and roof deck constructions are covered by the FM Approval. Further details of the current FM Approved thicknesses and roof deck constructions can be located on [www.fmapprovals.com/roofnav](http://www.fmapprovals.com/roofnav) or [www.roofnav.com](http://www.roofnav.com) by searching 'Kingspan QuadCore® 426'. Alternatively please contact Kingspan Insulation's Technical Service Department (see rear cover for details).

## Thermal Properties

The  $\lambda$ -values and R-values detailed below are quoted in accordance with BS / I.S. EN 13165: 2012 + A1: 2015 (Thermal insulation products for buildings - Factory made rigid polyurethane foam (PU) products - Specification).

### Thermal Conductivity

The boards achieve a thermal conductivity ( $\lambda$ -value) of 0.021 W/mK.

### Thermal Resistance

Thermal resistance (R-value) varies with thickness and is calculated by dividing the thickness of the board (expressed in metres) by its thermal conductivity. The resulting number is rounded down to the nearest 0.05 (m<sup>2</sup>K/W).

Insulant Thickness (mm)	Thermal Resistance (m <sup>2</sup> K/W)
100	4.762
105	5.000
110	5.238
115	5.476
120	5.714
125	5.952
130	6.190
135	6.429
140	6.667
145	6.905
150	7.143

NB Refer to local distributor or Kingspan Insulation price list for current stock and non-stock sizes.

---

# Kingspan Insulation

---

## Company Details

Kingspan Insulation Ltd is part of the Kingspan Group plc., one of Europe's leading construction product manufacturers. The Kingspan Group was formed in the late 1960s and is a publicly quoted group of companies headquartered in Kingscourt, County Cavan, Ireland.

Kingspan Insulation Ltd is a market leading manufacturer of premium and high performance rigid insulation products and insulated systems for building fabric and building services applications.

---

## Products & Applications

Kingspan Insulation Ltd has a vast product range. Kingspan Insulation Ltd products are suitable for both new build and refurbishment in a variety of applications within both domestic and non-domestic buildings. The available insulation solutions are listed below.

- Pitched Roofs
- Flat Roofs
- Green Roofs
- Cavity Walls
- Solid Walls
- Timber and Steel Framing
- Insulated Cladding Systems
- Insulated Render Systems
- Floors
- Soffits
- Ductwork

### Further Solutions:

- Insulated Dry-Lining
- Tapered Roofing Systems
- Cavity Closers
- The Kingspan KoolDuct® System
- Kingspan nilvent®
- Kingspan TEK® Building System

## Insulation Product Benefits

### Kingspan OPTIM-R® Vacuum Insulation Panel (VIP) Products

- With a declared value thermal conductivity of 0.007 W/mK, these products provide an insulating performance that is up to five times better than commonly used insulation materials.
- Provides high levels of thermal efficiency with minimal thickness.
- Over 90% (by weight) recyclable.

### Kingspan Kooltherm® and Kooltherm® 100 Products

- With a thermal conductivity of 0.018–0.023 W/mK these are the most thermally efficient insulation products commonly used.
- The thinnest commonly used insulation products for any specific U-value.
- Manufactured with a blowing agent that has zero Ozone Depletion Potential (ODP) and low Global Warming Potential (GWP).

### Kingspan QuadCore®

- With a thermal conductivity of 0.021 W/mK this is amongst one of the more thermally efficient insulation products commonly used.
- Offering excellent thermal and fire performance, enhanced environmental credentials and backed by an extended warranty.
- Manufactured with a blowing agent that has zero Ozone Depletion Potential (ODP) and low Global Warming Potential (GWP).

### Kingspan Therma™ Products

- With a thermal conductivity of 0.022–0.028 W/mK these are amongst the more thermally efficient insulation products commonly used.
- Manufactured with a blowing agent that has zero Ozone Depletion Potential (ODP) and low Global Warming Potential (GWP).

### Kingspan GreenGuard® Products

- Rigid extruded polystyrene insulation (XPS) has the necessary compressive strength to make it the product of choice for specialist applications such as heavy duty flooring, car park decks and inverted roofing.
- Manufactured with a blowing agent that has zero Ozone Depletion Potential (ODP) and low Global Warming Potential (GWP).

### All Products

- Unaffected by air infiltration - a problem that can be experienced with mineral fibre and which can reduce thermal performance.
- Safe and easy to install.
- If installed correctly, can provide reliable long term thermal performance over the lifetime of the building.
- Each product achieves the required fire performance for its intended application.



---

# Contact Details

---

## UK

**Kingspan Insulation Ltd**  
Pembroke | Leominster  
Herefordshire | HR6 9LA

T: +44 (0) 1544 388 601

F: +44 (0) 1544 388 888

E: [info@kingspaninsulation.co.uk](mailto:info@kingspaninsulation.co.uk)

[www.kingspaninsulation.co.uk](http://www.kingspaninsulation.co.uk)

For individual department contact details please visit  
[www.kingspaninsulation.co.uk/contact](http://www.kingspaninsulation.co.uk/contact)

---

## Ireland

**Kingspan Insulation Ltd**  
Castleblayney | County Monaghan

T: +353 (0) 42 979 5000

F: +353 (0) 42 975 4299

E: [info@kingspaninsulation.ie](mailto:info@kingspaninsulation.ie)

[www.kingspaninsulation.ie](http://www.kingspaninsulation.ie)

For individual department contact details please visit  
[www.kingspaninsulation.ie/contact](http://www.kingspaninsulation.ie/contact)

Kingspan Insulation Ltd. reserves the right to amend product specifications without prior notice. Product thicknesses shown in this document should not be taken as being available ex-stock and reference should be made to the current Kingspan Insulation price-list or advice sought from Kingspan Insulation's Customer Service Department. The information, technical details and fixing instructions etc. included in this literature are given in good faith and apply to uses described. Recommendations for use should be verified for suitability and compliance with actual requirements, specifications and any applicable laws and regulations. For other applications or conditions of use, Kingspan Insulation offers a Technical Advisory Service, the advice of which should be sought for uses of Kingspan Insulation products that are not specifically described herein. Please check that your copy of this literature is current by contacting the Kingspan Insulation Marketing Department.

© Kingspan, KoolDuct, Kooltherm, nilvent, OPTIM-R, QuadCore, Kingspan GreenGuard, TEK, Thermaroof and the Lion Device are Registered Trademarks of the Kingspan Group plc in the UK, Ireland and other countries. All rights reserved.

TM Therma are Trademarks of the Kingspan Group plc.

Kingspan Insulation Ltd is not associated with, and its products have not necessarily been tested by, the GREENGUARD Environmental Institute.

Registered in England & Wales, No. 01882722. Registered Office: Pembroke, Leominster, Herefordshire HR6 9LA UK. VAT GB428602456.

Registered in Ireland, No. 54621. Registered Office: Bree Industrial Estate, Castleblayney, Co. Monaghan, Ireland. VAT IE4575069I.

